

WALPOLE WILDERNESS



www.walpolewilderness.org

OCTOBER 1 & 2, 2022

SCHEDULE OF ACTIVITIES

Walpole Wilderness Bioblitz 2022

Schedule of Activities

This year we have focused the WWBB on the Red Tingle forest. This is the only Red Tingle forest in the world and it is only found within a 20km radius of Walpole. We have chosen the survey area to encompass a range of ecosystems (besides the tingle) to increase the opportunity for recording a greater variety of species. The survey area also has a range of ages since the last fire (fire is a significant factor in influencing biodiversity). You will have the opportunity to explore the Tingle forest, Jarrah woodlands, heath lands and peat. Tingle forest has a relatively low diversity when it comes to plants, but is very rich in cryptogams (mosses, lichens and fungi) and invertebrates, whilst the Jarrah and heathlands can be rich in proteaceous (banksias etc) and other plant species.

The weekend will be divided into 3 sessions – each of 3 hours (Saturday morning, Saturday afternoon and Sunday morning). Below is a list of survey sites that we have allocated to each session. Each group will be limited to about 8-10 people and some survey sites will be visited more than once. Every site has something special to offer. Have a look through the list and earmark those sites that interest you most, then head over to our volunteering webpage and pop your name on that particular site list. Whilst we have carefully planned the site locations and team leaders for the weekend, circumstances may change and some sites may not end up getting surveyed and some new sites may be created – please be prepared to be flexible.

Given the beauty of the Tingle forest, we have tried to create the opportunity for everyone to partake in at least one session in the tingles. Children are welcome to accompany their parents on any of the activities, but we have scheduled some activities that are more geared towards children (parent/guardian supervision still needed). Most of the survey locations are reached by walking along 4WD tracks. Once at a survey location access will be “off-trail” which means uneven ground, fallen branches and pushing through vegetation – generally only for a short distance.



Typical tingle forest is generally quite dense with thick leaf litter and fallen branches. Be prepared for uneven terrain and awesome ambience!

Friday 30th September

17.00- 19.00

Briefing at the Walpole Country Club

17.30 Presentation on Tingle/ Peat/Jarrah ecosystems and WWBB 2022

20.00 – 21.30

Night Stalk at the Giant Tingle Tree Carpark

Join us for a look into the night world of the Tingle forest. Make your own way by vehicle to the car park of the Giant Tingle Tree on Hilltop Road. Here you will join our guides to look for some of the cryptic creatures of the night.



An example of jarrah forest for the WWBB 2022. It has a more closed canopy and can be quite dense to walk through but is rich in biodiversity.

SATURDAY Morning October 1st

8.30

Assemble at Base Camp for acknowledgement to country and sort into groups for 9.00 start

9.00 – 12.00

Site 1 Sword Grass Valley

This is a small section of Tingle forest, leading down to a creekline on the south. It is located about 100 metres east from base camp. This is an ideal spot for those not wanting to walk long distance with plenty of opportunity for invertebrates, mosses, lichens and plants. You can explore both sides of the road here – the south side is about 20 years post fire and the north side about 5 years.

Site 2 Tangled Tea Trees

Explore some lower growing vegetation in this tea-tree heathland. This site is located about 100 metres west of base camp. Located to the south of the road, the edge of the road has been burned more recently leading to the collapse of the tea trees. This area has good heathland botanical diversity. Further in from the road (about 30 metres south) the tea tree hasn't been burned and remains more open with less understory. A good site for hammer orchids. You can continue your exploration down along the length of the road.

Site 3 Lost Plots I

About 30 years ago, some 20 x 20m plots were created along the road and all of the vegetation within the plot was recorded. We are planning to recreate these plots which will give us a great opportunity to see how the vegetation has changed in response to a drying climate and fire over the last few decades. This first plot is located about 100m west of Base Camp and is easily accessible. Once the plot has been marked and the plant species recorded, there may be time to further explore this area down towards the wetland.

Site 4/5 Tingle Palace *** (Sat AM/PM & Sun AM)

Enter the world of the open Tingle forest. Dominated by the two large species of tingle (Red & Rate) with some Yellow scattered throughout. Estimated to be 30 – 50 years since the last burn, the openness of this forest gives you a rare opportunity to experience the glory of this rare forest type. There will be several activities at this site as it has much to explore. This is a beautiful location and well worth a visit. The site is located approximately 700 metres west of base camp and is best entered along a quokka trail on the east side of the creek. Keep an eye out for the epiphytic cryptogams (see below). There will be two groups heading into this area, then splitting up for the survey.

Site 6 Slow Creek

This walk will be one for the photographers amongst us. The idea being that the pace of the walk will be quite slow to allow for everyone to stop and take more in-depth photos. Located approximately 750 metres west of Base Camp, enter the forest on the east side of the creek line and follow the creek down for about 200 metres. The creek comes and goes as it disappears underground with another underground tributary feeding in from the east. Look for the most ancient of Tingles east of the creek and continue a bit further south to an open area allowing access to the creek gully itself.

Site 7 Northern Jarrah Wood

Walk approximately 1.1km west from Base Camp and look at the jarrah forest to the north side of the road (opposite a road heading south). This area was burned around 4 years ago and is a good representation of typical Walpole Wilderness jarrah, being rich in proteaceous species. Mostly a quartz sand substrate.

Site 8 Banksia Corner & Senile Peat

Located 1.1km west of Base Camp, you will be exploring the corner forest, located to the south of the road (and west of the intersecting track). Enter the forest about 50 metres down the side track and explore the area dominated by giant Banksia trees (there are lots of unusual lichens on the bark of these trees). Estimated time since fire – 13 years. We will then head into an extraordinary peat that appears to have escaped fire and created its own unique ecosystem. Keep an eye out for the epiphytic cryptogams (see below).

Site 9 Laterite Ridge West

This site is approximately 1.5km walk from Base Camp. Walk the road to the west for 1km then take the side road to the left (south). Follow this road around to the top of the lateritic ridge and head into the forest on the west (right hand side) of the road. This is an area that was last burned around 6 years ago and leads from jarrah into low lying heath.

Site 10 Laterite Ridge East

This site is approximately 1.5km walk from Base Camp. Walk the road to the west for 1km then take the side road to the left (south). Follow this road around to the top of the lateritic ridge and head into the forest on the east (left hand side) of the road. This area was last burned about 14 years ago. It starts off as jarrah forest and leads into more mixed jarrah/karri and tingle.

Site 11 Cemetery Bog

This is a large basin peatland that contains a number of rare species. Access is via a 1.5km walk (one-way) along the road and then a short (30 metre) push through Jarrah to the edge of the peat. This peat is not for the faint hearted as it has dense vegetation and in places can be waist deep. Numbers will be limited to avoid damage to the peat. Approximately 7 years since last burnt.

Site 12 Big Trees Big Carbon*** (Sat AM/PM & Sun AM)

Tingle forests are an enormous store of carbon, much of which is released during fire. Help PhD candidate Nate in his research by locating individual trees and measuring their girth, fire scars and hollow formations. After the fire (in the next 6 months) these trees will be revisited to assess their status and overall carbon status. You will need to 4WD carpool to get to the site and will be walking through some long unburnt tingle forest. The terrain may be variable and quite dense in some places.

Site 13 Easy Access Tingle - kids

From Base Camp head about 30 metres to the west and take an old track to the North. Follow this track for about 250 metres and you will be in some lovely tingle forest that has recently been burned (about 2 years ago). This is a great spot for bird spotting, invertebrate hunting and plant ID. Great for kids

Site 14 Tingle Forest Creek**

From Base Camp head east to the bottom of the hill (about 350 metres). Cross over the creek and head into the Tingle forest on the right hand side of the road. This site has a grand old hollow-butt overlooking the creek and is deep in leaf litter. Great spot for cryptogams and invertebrates.

Site 15 The Tingle Jungle *** (Sat AM/PM & Sun AM)

Follow the track that heads north (about 30 metres west of Base Camp). Walk through the more recently burned area for approximately 300 metres until you reach Hilltop Road. Carefully cross over the road into some Tingle forest. The first bit of this forest is about 15 years since fire, but heading in about 50-100 metres, the forest is about 35 years since fire. This is a spectacular bit of forest which is a very dense, litter strewn bit of forest and is one for those who are comfortable walking in tougher conditions. You may even get to see the enormous twingles!

Site 16 Birds with Birds WA/Denmark Bird Group*** (Sat AM/PM & Sun AM)

Join a team of bird enthusiasts and experts to explore the area for local birds. This group will carpool and head away from basecamp, exploring some of the sidetracks in the wilderness. BYO binoculars and camera.

Site 17 Look & Listen & drink coffee*** (Sat AM/PM & Sun AM)

Grab a coffee, put your feet up and relax at the WW Hub (Petrichor Gallery) where you can go through photos from the camera traps that have been active in the weeks prior to the blitz. This is a great opportunity to see what mammals are hiding in the forest. We will also have recordings from a songmeter which has been recording the sounds at dawn and dusk. We are hoping to hear some of the rarest owls (the Barking Owl and the Masked Owl).

** This activity will be held on 2 occasions

*** This activity will be held over 3 occasions

LUNCH

12.00 – 13.00

Return to Basecamp for lunch break (BYO) and regroup with the other participants, before heading out to your next activity.

SATURDAY Afternoon October 1st

13.00 – 16.00

Site 18 Tingle Palace * (Sat AM/PM & Sun AM)**

Enter the world of the open Tingle forest. Dominated by the two large species of tingle (Red & Rate) with some Yellow scattered throughout. Estimated to be 30 – 50 years since the last burn, the openness of this forest gives you a rare opportunity to experience the glory of this rare forest type. There will be several activities at this site as it has much to explore. This is a beautiful location and well worth a visit. The site is located approximately 700 metres west of base camp and is best entered along a quokka trail on the east side of the creek. Keep an eye out for the epiphytic cryptogams (see below). There will be two groups heading into this area, then splitting up for the survey.

Site 19 Tingle Forest Creek**

From Base Camp head east to the bottom of the hill (about 350 metres). Cross over the creek and head into the Tingle forest on the right hand side of the road. This site has a grand old hollow-butt overlooking the creek and is deep in leaf litter. Great spot for cryptogams and invertebrates.

Site 20 Perched Peat (Sat PM & Sun AM)**

Car pool with your team leader and head out for a short drive to a recently burned (12 months) bit of forest. There will be a short 300 metre walk into a fantastic peatland that sits high above the Frankland River. Hunt for classic peat species, carnivorous plants, orchids and more.

Site 21 Scabra Sedgelands

Recently burned (12 months) ago, these sedgelands are now easily accessible. Share a short 4WD car pool to the site then walk in from the edge of the road to the grasslands. To the south there is an island stand of jarrah heading down to a creek which will provide a different suite of species to the sedgelands. Numerous pools can be found throughout the sedgelands giving the opportunity to look for aquatic fauna.

Site 22 Big Trees Big Carbon* (Sat AM/PM & Sun AM)**

Tingle forests are an enormous store of carbon, much of which is released during fire. Help PhD candidate Nate in his research by locating individual trees and measuring their girth, fire scars and hollow formations. After the fire (in the next 6 months) these trees will be revisited to assess their status and overall carbon status. You will need to 4WD carpool to get to the site and will be walking through some long unburnt tingle forest. The terrain may be variable and quite dense in some places.

Site 23 Autopsy of a Tree – kids

Join one of our excellent guides from the Valley of the Giants Tree Top Walk and discover what happens when a tree falls in our forest. Look at all the new life that springs when one of our giants falls. This activity will be located a few hundred metres from basecamp.

Site 24 Gravel Pit

Long disused gravel pits often provide opportunities for species that thrive with the lack of competition. This site is located approximately 1.5 east of Base Camp. Follow the road and cross

over Hilltop Road. Follow the road down the hill and look for the marker indicating a good point to access the gravel pit. A short 20-30 metre walk will get you into a gravel pit that has been out of commission for some 40 years and contains a range of species.

Site 25 Hilltop Corner NE

Heading east from Basecamp, cross over Hilltop Road onto Creek Road – about a 700m walk. On your left (north) is some open jarrah/heath. Here we will do a general survey in an area that has good botanical diversity. This area is about 7-8 years post fire.

Site 26 Hilltop Corner SE

Follow the road to the east and cross over Hilltop Road (700m) onto Creek Road. Go about another 100m - on the south (right) side of the road enter the jarrah forest. This is an area of open jarrah that heads into jarrah/tingle/karri further up slope. Much of this area is long unburnt – about 30 years since fire. It is quite dense bush but will be worth the effort.

Site 27 Hilltop Corner NW

Head east from Basecamp for approximately 700 metres towards the intersection of Hilltop Road. Explore the area on the north (left) side of Cemetery/Creek Road. This is an area of open Jarrah/heath on a quartz substrate and is about 7 years post fire.

Site 28 Jarrah Heath

Take the road east from Base Camp for about 600 metres. As you head up the hill, the vegetation changes from Tingle/riparian to more open Jarrah heathland. The bush on the left (north) side of the road is about 7 years post fire and appears to be rich in Epacridaceae and Proteaceae.

Site 29 Lost Plots II

About 30 years ago, some 20 x 20m plots were created along the road and all of the vegetation within the plot was recorded. We are planning to recreate these plots which will give us a great opportunity to see how the vegetation has changed in response to a drying climate and fire over the last few decades. There are 2 plots located about 1.4km and 1.5km from Base Camp.

Site 30 The Tingle Jungle *** (Sat AM/PM & Sun AM)

Follow the track that heads north (about 30 metres west of Base Camp). Walk through the more recently burned area for approximately 300 metres until you reach Hilltop Road. Carefully cross over the road into some Tingle forest. The first bit of this forest is about 15 years since fire, but heading in about 50-100 metres, the forest is about 35 years since fire. This is a spectacular bit of forest which is a very dense, litter strewn bit of forest and is one for those who are comfortable walking in tougher conditions. You may even get to see the enormous twingles!

Site 31 Birds with Birds WA/Denmark Bird Group*** (Sat AM/PM & Sun AM)

Join a team of bird enthusiasts and experts to explore the area for local birds. This group will carpool and head away from basecamp, exploring some of the sidetracks in the wilderness. BYO binoculars and camera.

Site 32 Look & Listen & drink coffee*** (Sat AM/PM & Sun AM)

Grab a coffee, put your feet up and relax at the WW Hub (Petrichor Gallery) where you can go through photos from the camera traps that have been active in the weeks prior to the blitz. This is a

great opportunity to see what mammals are hiding in the forest. We will also have recordings from a songmeter which has been recording the sounds at dawn and dusk. We are hoping to hear some of the rarest owls (the Barking Owl and the Masked Owl).

Site 33 Fungi ID

Spend the afternoon with a fungi specialist and other botanists at the hub examining samples under the microscope.

** This activity will be held on 2 occasions

*** This activity will be held over 3 occasions

Typical open jarrah forest/ heathland has a mix of small trees often with a tea-tree understory. These areas are often more easily accessible with uneven terrain and some pushing through vegetation.



SUNDAY Morning October 2nd

9.00 – 12.00

Site 34 Tingle Palace *** (Sat AM/PM & Sun AM)

Enter the world of the open Tingle forest. Dominated by the two large species of tingle (Red & Rate) with some Yellow scattered throughout. Estimated to be 30 – 50 years since the last burn, the openness of this forest gives you a rare opportunity to experience the glory of this rare forest type. There will be several activities at this site as it has much to explore. This is a beautiful location and well worth a visit. The site is located approximately 700 metres west of base camp and is best entered along a quokka trail on the east side of the creek. Keep an eye out for the epiphytic cryptogams (see below). There will be two groups heading into this area, then splitting up for the survey.

Site 35 Tingle Forest Creek*** (Sat AM/PM & Sun AM)

From Base Camp head east to the bottom of the hill (about 350 metres). Cross over the creek and head into the Tingle forest on the right hand side of the road. This site has a grand old hollow-butt overlooking the creek and is deep in leaf litter. Great spot for cryptogams and invertebrates.

Site 36 Perched Peat** (Sat PM & Sun AM)

Car pool with your team leader and head out for a short drive to a recently burned (12 months) bit of forest. There will be a short 300 metre walk into a fantastic peatland that sits high above the Frankland River. Hunt for classic peat species, carnivorous plants, orchids and more.

Site 37 Big Trees Big Carbon*** (Sat AM/PM & Sun AM)

Tingle forests are an enormous store of carbon, much of which is released during fire. Help PhD candidate Nate in his research by locating individual trees and measuring their girth, fire scars and hollow formations. After the fire (in the next 6 months) these trees will be revisited to assess their status and overall carbon status. You will need to 4WD carpool to get to the site and will be walking through some long unburnt tingle forest. The terrain may be variable and quite dense in some places.

Site 38 Frog Hunt

Car pool and head out to some strategic locations to look and listen for frogs. We should be able to locate some of the more common frogs but we will be particularly aiming to hear the rare Walpole Frog.

Site 39 The Tingle Jungle *** (Sat AM/PM & Sun AM)

Follow the track that heads north (about 30 metres west of Base Camp). Walk through the more recently burned area for approximately 300 metres until you reach Hilltop Road. Carefully cross over the road into some Tingle forest. The first bit of this forest is about 15 years since fire, but heading in about 50-100 metres, the forest is about 35 years since fire. This is a spectacular bit of forest which is a very dense, litter strewn bit of forest and is one for those who are comfortable walking in tougher conditions. You may even get to see the enormous twingles!

Site 40 Jarrah Interface

Follow the road to the west for 800m. After you cross the creek, head up the slope for a short distance and pop into the forest on your right (north). This bit of forest changes from Tingle to Jarrah and then into more open, sandy, heath. It has been recently burned (about 3 years ago).

Site 41 Woodland corner

Approximately 1km west of base camp is a track heading off to the south (left). Head just past the track and survey the Jarrah woodland on the South-west corner of the track. This is a good area of jarrah forest that was last burned about 5 years ago.

Site 42 Open Jarrah

Explore some open Jarrah woodland containing a broad suite of species. There should be plenty of plants in flower so take the opportunity to look for interesting pollinators and predators. This is located about 1.3km west of basecamp and on the north side (right) of the road.

Site 43 Low heath

Walk the road to the west for 1km then take the sandy track to the south (on your left). Follow this road to the junction and on the west is some low heathland that was last burned about 5 years ago. There should be a good mix of species.

Site 44 Hilltop Corner SW

Head east from Basecamp for approximately 700 metres towards the intersection of Hilltop Road. Explore the area on the south (right) side of Cemetery/Creek Road. Some of this area may be more dense than the other due to it being burned more recently (5 or 35 years) which will give you a good side by side comparison of biodiversity in different fuel ages.

Site 45 Collier Rock

A shallow, sloping granite heads down towards Collier Creek. It is a short drive from Base Camp (head west from Base camp, turn left at the sandy track, then left into Gully Road. Go down the valley and about 100m up the other side and turn right into Collier Road). The granite is 200 metres on your right. The area was burned about 3 years ago and with some interesting species to be found on the rock and in the adjacent forest.

Site 46 Woodland walk – kids

Wander through some of the more open woodland and look for weird and wonderful flowers and the insects that love them. This will be located a short walk from base camp. Take the track heading north (about 30m west of basecamp) and look for the vehicle tracks to the left (about 50 metres in). Follow this track down and see what we can find!

Site 47 Birds with Birds WA/Denmark Bird Group*** (Sat AM/PM & Sun AM)

Join a team of bird enthusiasts and experts to explore the area for local birds. This group will carpool and head away from basecamp, exploring some of the sidetracks in the wilderness. BYO binoculars and camera.

Site 48 Look & Listen & drink coffee*** (Sat AM/PM & Sun AM)

Grab a coffee, put your feet up and relax at the WW Hub (Petrichor Gallery) where you can go through photos from the camera traps that have been active in the weeks prior to the blitz. This is a great opportunity to see what mammals are hiding in the forest. We will also have recordings from a songmeter which has been recording the sounds at dawn and dusk. We are hoping to hear some of the rarest owls (the Barking Owl and the Masked Owl). By now there should be plenty of samples to look at under the microscope and identify.

** This activity will be held on 2 occasions

*** This activity will be held over 3 occasions

Epiphytic Cryptogams

*Keep an eye out for this amazing ecological community during the WWBB. Cryptogams are species that reproduce by spores (think fungi, moss and liverworts). A unique array of species occur on trunks and branches of several species of shrubs/trees (mostly those that don't shed their bark). Take the time to examine the trunks of these trees, using a magnifying glass or zoom in on your phone, and record these beautiful species. One group – those that grow on *Trymalium* and *Chorilaena*, in long unburned country, are formally recognised as a Priority Ecological Community (PEC 3).*

The aim of the bioblitz is to record as many species as possible using the online platform of iNaturalist. Try and grab every opportunity to record species, whether common or rare. It is also important to try and capture the structure and aesthetic of the area you are working in. This does not get recorded by iNaturalist (please don't load landscape photos onto iNaturalist). Instead, the WNNPA would like to collate all of this information separately. This is really important as the influences of climate change and fire are dramatically influencing the landscapes of the Walpole Wilderness – it won't look this way forever. Great landscape photos (and great people photos) are important to us, so please email us copies of your pictures and tag us on social media (@walpolewilderness on Instagram and Walpole-Nornalup National Park Association on Facebook).

SUNDAY Afternoon October 2nd

As many people are heading back home on Sunday, we will not have any formal activities. We will be packing up the equipment and heading back to the Wilderness Hub where we will continue the process of analysing, identifying, photographing and recording specimens. We will put the urn on, so bring your lunch and join us for a cuppa and a debrief.

NB The Wilderness Hub is located in the courtyard next to Petrichor Gallery

Walpole Wilderness BIOBLITZ 2022 Area

SATURDAY Morning

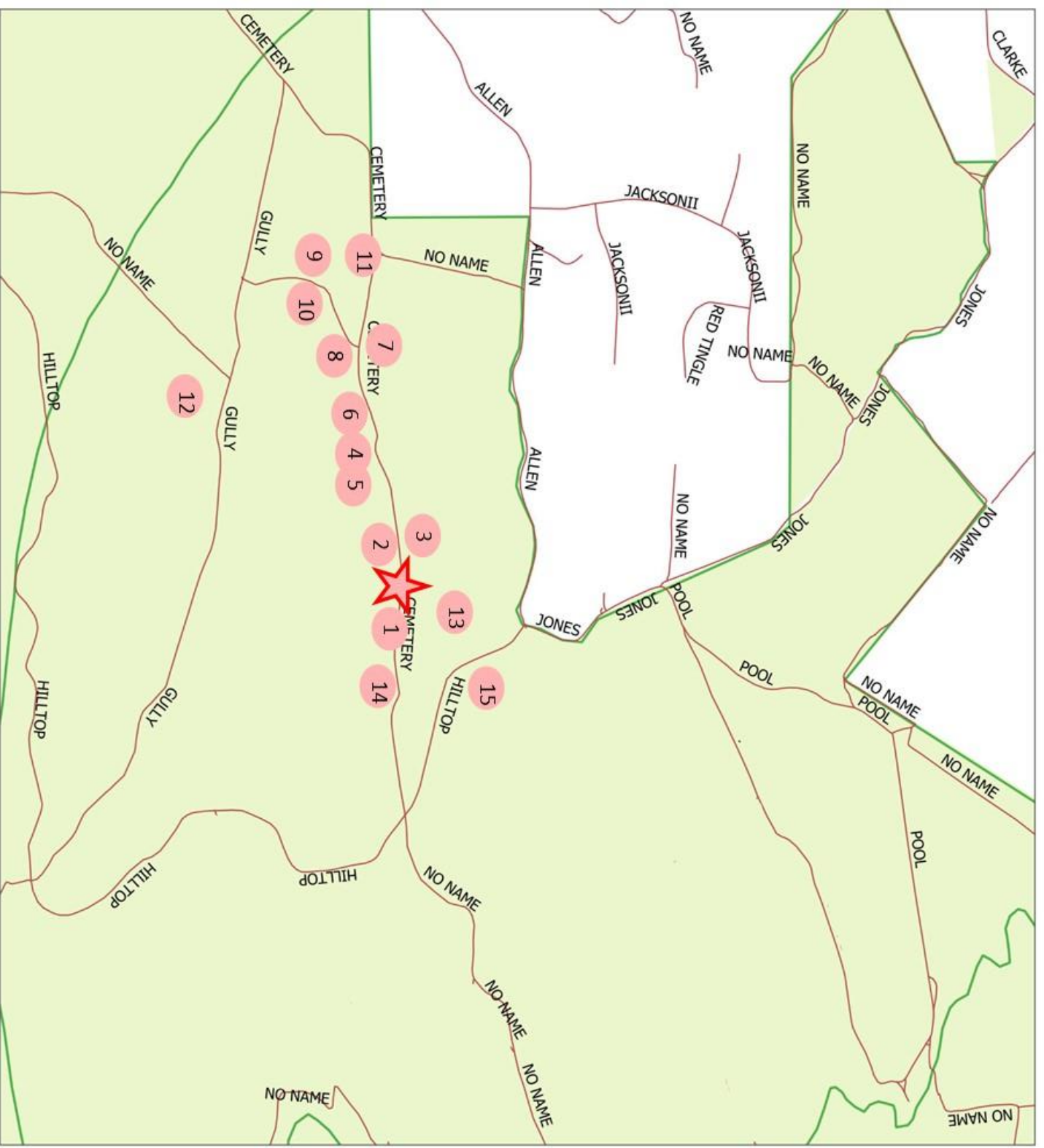

Activities held offsite

- 16
- 17

- WWBB 2022 Area
- Roads
- Conservation Estate

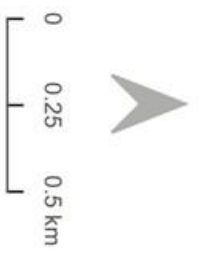

Walpole Wilderness BIOBLITZ 2022 Area

SATURDAY Afternoon

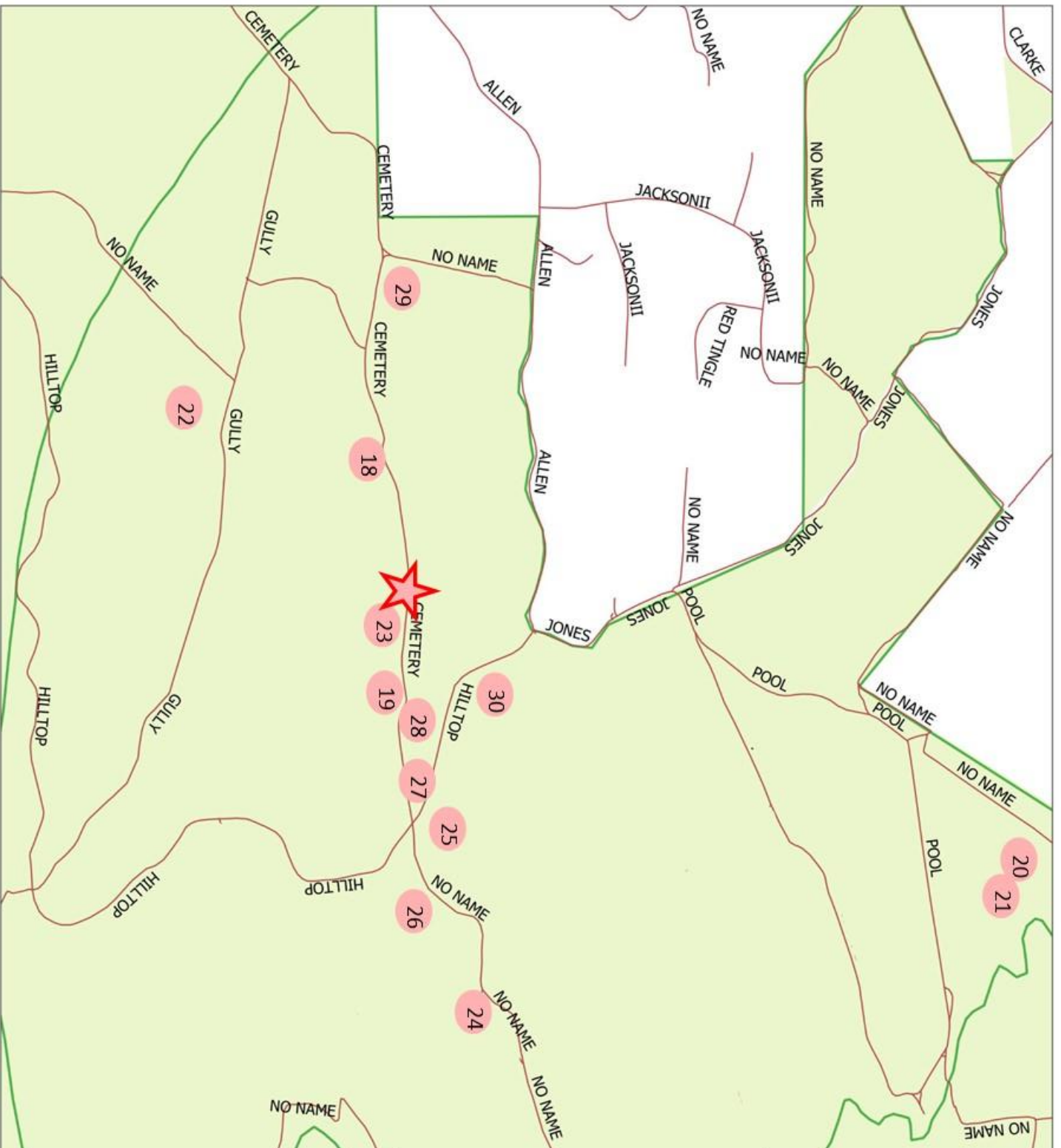

Activities held offsite 31

32

33

WWBB 2022 Area

Roads

Conservation Estate

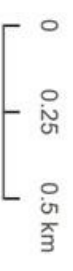

Walpole Wilderness BIOBLITZ 2022 Area

SUNDAY morning

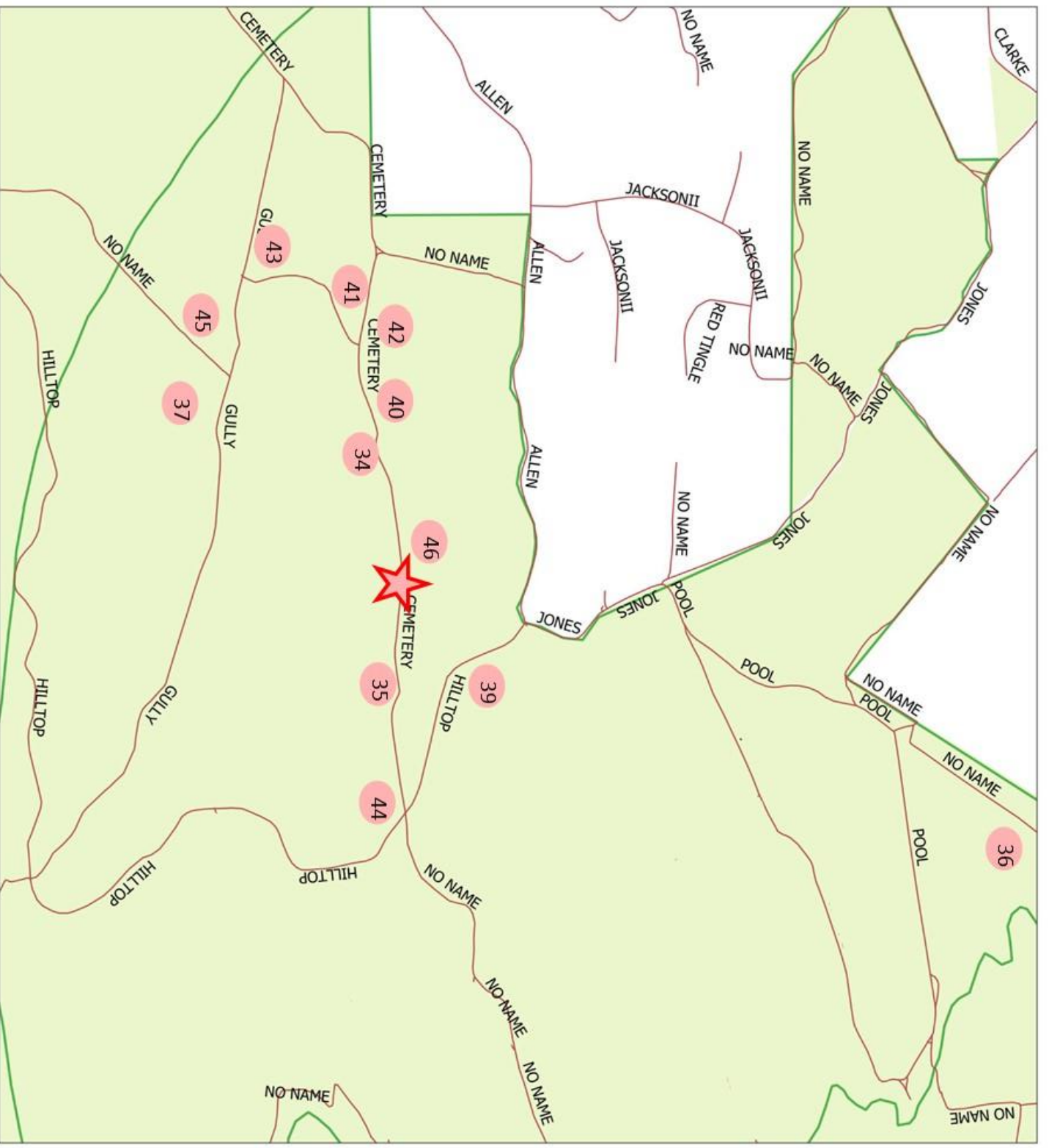

Activities held offsite

- 38
- 47
- 48

- WWBB 2022 Area
- Roads
- Conservation Estate

